

ENHULK

20V Handheld Pool Cleaner PCT403T

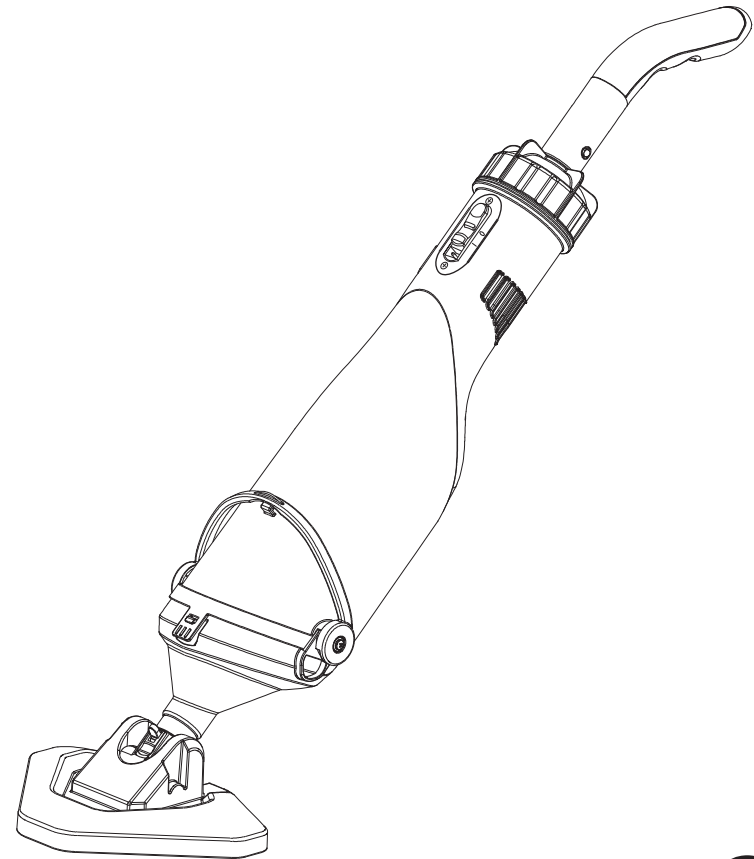

SYVIO TECHNOLOGY CO., LIMITED
Room A, 8/F, Kwok Cheung Building, 635-637
Shanghai Street, Mong Kok, Hong Kong
0086-133-2298-6467
service@enhulktools.com



**Please Read Carefully Before Use
Original Instruction Manual**

General Pool Cleaner Safety Warnings

⚠ WARNING! Read all safety warnings, instructions, illustrations and specifications provided with this pool cleaner. Failure to follow all instructions listed below may result in electric shock, fire and/or serious injury.

- Please read the instructions for use very carefully and observe the information they contain. By referring to these instructions, familiarize yourself with the cleaner, learn how to use it correctly, and note the safety precautions to be taken.
- Never allow children to operate this product. This is NOT a toy. Children should be supervised to ensure they do not play with this product.
- Keep the cleaner and its accessories out of reach of children.
- The user of the cleaner is responsible for any third parties in the work area.

Electrical Safety

⚠ WARNING! DROWNING HAZARD. This device produces suction. Risk of entrapment present. DO NOT use when bathers are present. Never permit children to use this product. Never permit persons who cannot swim to use this product to prevent the chance of drowning.

- This cleaner can be used by children aged from 8 years and above persons with reduced physical, sensory or mental capabilities lack experience knowledge if they have been given supervision instruction concerning use in a safe way understand hazards involved. Children shall not play cleaner. Cleaning user maintenance made without supervision.
- If the equipment is damaged, it must be replaced by the manufacturer, its service agent or similarly qualified persons in order to avoid a hazard.
- Please contact your electrician!
- Use the cleaner only for the purposes specified in these instructions for use.
- You are responsible for safety in the work area.
- When charging make sure that cleaner is plugged into a socket in a place where there is no risk of flooding and which is protected against moisture.
- If the Pool Cleaner fails, any repair work necessary must be performed only by an electrician.
- Never let the run dry and never operate it with fully closed intake power. The manufacturer's warranty shall lapse if the cleaner is damaged due to it being allowed to run dry.

- Water temperature range: 39 ° F(4 ° C)- 95 ° F (35 ° C).
- Please turn off the cleaner before charging.
- To avoid unnecessary harm, hairs, body, or clothes should keep away from the dirt sucker, because it has a suction force when it works.
- Do not dismantle the cleaner arbitrarily.
- Please use the original charger to charge the cleaner.
- Please place the cleaner indoors with good ventilation, clean, and dry condition when it is charging.
- If there is any damage to the charger, please stop charging.
- Please ensure that the cleaner and charger are dry before charging.
- The cleaner is specially designed for the underwater environment, rather than a universal cleaner.
- Please avoid using the cleaner to clean sharp objects, otherwise, the cleaner and filter net will be damaged.

Warning For Charger

- The charger must not be used for non-rechargeable, ordinary batteries.
- Adequate ventilation is required.
- The information on current and voltage on the battery pack must comply with those of the charger.
- Do not expose the charger to water splashes and rain.
- Place the charger far from any heat source. To reduce the risk of electric shock, pull the plug instead of the power cord out from the socket, if you want to disconnect the charger from the mains.
- Do not disassemble the charger. Bring it to an authorized repair service, if service or repair is required. Improper installation can result in electrical shock, death and fire.
- This appliance can be used by children aged from 8 years and above and persons with reduced physical, sensory or mental capabilities or lack of experience and knowledge if they have been given supervision or instruction concerning use of the appliance in a safe way and understand the hazards involved.
- Children shall not play with the appliance.
- Cleaning and user maintenance shall not be made by children.
- Do not leave the equipment unattended while it is operating, to avoid the risk of fire, burns and electric shocks.
- If the power cord is damaged, it must be replaced by the manufacturer or its customer service or a similarly qualified person in order to avoid.
- Charge only battery pack of the same model provided by ENHULK and of models recommended by ENHULK.

Safety Instruction

Warning For Battery

- The pool cleaner battery is a lithium battery, it must be disposed properly, please contact with your local authority for more information.
- Never attempt to disassemble the lithium battery.
- Do not throw exhausted or damaged batteries into water or fire. Environmental guidelines must be followed.

Symbols



Class II
appliance



Read the
operator's
manual



Do not
burn

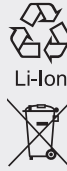

Li-Ion

Li-Ion battery This product has been marked with a symbol relating to 'separate collection' for all battery packs and battery pack. It will then be recycled or dismantled in order to reduce the impact on the environment. Battery packs can be hazardous for the environment and for human health since they contain hazardous substances.

Product Description

Product Features

Diagram of the pool cleaner on the graphics page.

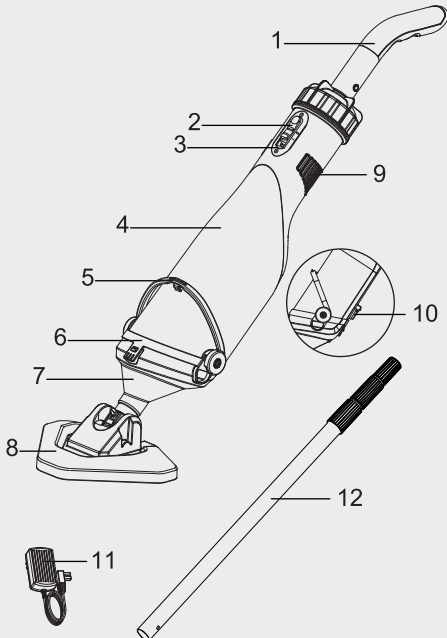

1. Portable Handle
2. Switch
3. Charging Interface
4. Main Pump Casing
5. Locking Handle
6. Filter Bag
7. Cleaner Cover
8. Vacuum Head
9. Outlet Holes
10. Check Valve
11. Charger
12. Telescoping Tube

Technical Data

Handheld Pool Cleaner

Article number	PCT403T
Voltage	DC 20V
Battery Capacity	2.0Ah
Charger Capacity	21.5V 1.5A
Max. Particle Size	1in 25mm
Max. Water Temperature	95°F 35°C
Max. Submersion Depth	10ft 3m
Moisture protection	IPX8

Operating Instructions

Assembly

⚠ WARNING!

Read carefully and understand all operating instructions before using this pool cleaner.

Installing The Vacuum Head

Insert the vacuum head into the cleaner cover. Make sure it is fully inserted in place, otherwise it may loosen from the filter when cleaning.

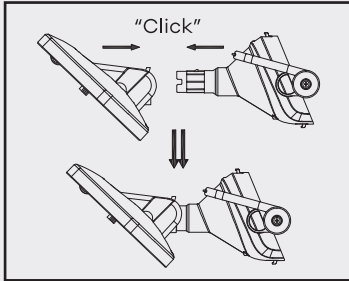

Installing The Filter Bag

Place the vacuum head on flat ground, install the filter bag seal ring correctly on the cleaner cover and fasten the buckles on both sides.

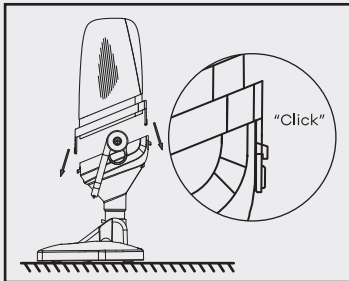

Installing The Main Pump Casing

1. Move the locking handle to the clean cover position, align the clasp and push to correct position.

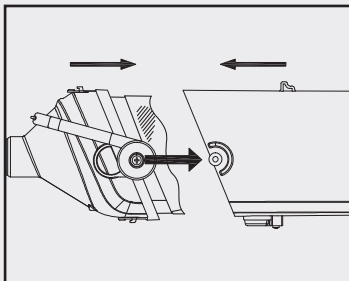

⚠ CAUTION

Install the filter bag seal ring correctly on the main pump casing and do not stick of the filter bag.

2. Snap the locking handle to the main pump casing and clamp it

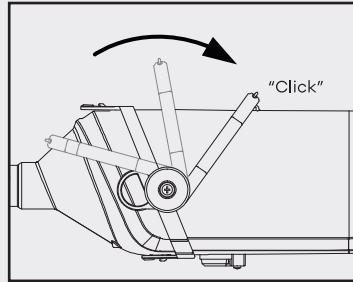

Installing The Portable Handle

Attach the portable handle by squeezing the spring buttons and inserting into handle of the pool cleaner body. Check the buttons pop into the holes.

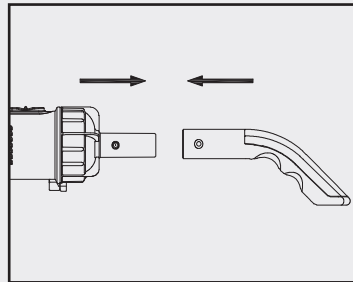

Installing The Telescoping Tube

Attach the telescoping tube by squeezing the spring buttons and inserting into handle of the pool cleaner body. Check the buttons pop into the holes. Adjust the length of the shaft by unlocking, extending and locking each section accordingly.

⚠ CAUTION

Do not overextend and vigorously stretch telescoping tube to adjust the length to avoid damage it.

Operating Instructions

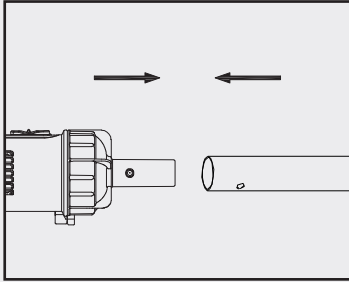

Switching On And Off

To switch on the pool cleaner, Push switch(2) to position "1". Please put the pool cleaner into the water for operation, so as to prevent the seal failure of the oil seal when the product is idling.
-To switch off the pool cleaner, Push switch(2) to position "0".

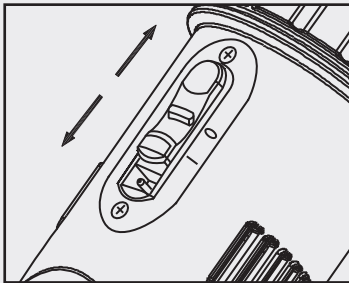

Operating The Pool Cleaner

Switching on the pool cleaner and put it into the water.

⚠ WARNING

The maximum temperature of the medium to be pumped in continuous operation should not exceed 95°F(35°C).

⚠ CAUTION

The priming water level of the pool should be higher than 1ft(30cm) when pool cleaner normal operation

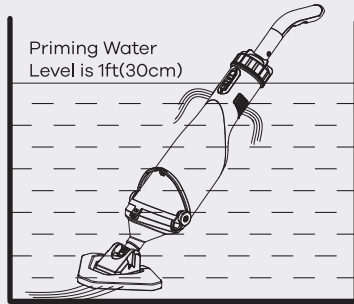

⚠ CAUTION

This pool cleaner can be used to cleaning small-scale swimming pool, fishpond, bathing pool, and landscaped pool. NOT for algae, combustible, gaseous or explosive fluids.

Charger The Pool Cleaner

1. For indoor charge only, DO NOT expose to water or rain.
2. Ensure that the connection between the battery charger and battery is correctly positioned and is not obstructed by foreign bodies.
3. Longer life and better performance can be obtained if the pool cleaner is charged when the air temperature is between 64° F(18° C) and 90° F(24° C). Do not charge the battery pack in air temperatures below 32° F(0° C), or above 104° F(40° C). This is important as it can prevent serious damage to the battery pack inside.

Your pool cleaner is UNCHARGED and you must charge once before use.

Normally, the relevant charger indicator light will be in red color showing the battery is being charged.

When it is fully charged, the light will change to green color.

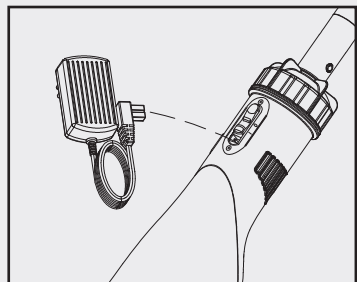

Troubleshooting

WARNING

To avoid dangers, all the installation including repair and replacement of components should be conducted by authorized service personnel. Before operating the cleaner, please turn off the device and unplug it

Problem	Reasons	Solutions
Fail to clean the waste	The battery runs out	Recharge the cleaner, and it can work for 50-60 minutes after being fully charged.
	The impeller is damaged	Correspond with the dealer to repair or replace the impeller.
	The impeller is blocked	Turn off the cleaner and check the impeller. Please correspond with professional personnel to clean the blockage in the impeller.
	The filter bag is full	Clean the waste in the filter bag.
Waste gets out from the front parts	Check Valve is damaged	Change the check valve.
Waste gets out from the filter bag	The filter bag is damaged	Change the filter bag.
Portable handle / telescoping tube fails to connect	The connective V-Cord is damaged	Change the V-Cord.
Cleaner fails to be charged	The battery pack inside is damaged	Correspond with the dealer to replace the battery pack. Warning! To avoid damaging the cleaner, please purchase the original lithium battery to replace.
	The charger is damaged	Correspond with the dealer to replace the charger. Warning! To avoid damaging the cleaner caused by the charger, please purchase the original charger to replace it.

Maintenance and transportation

Cleaning

Remove and clean the Filter Bag following each use.

When cleaning the filter bag, please release the locking handle, remove the cleaner cover attached to the filter bag, Loosen the buckles on both sides of the filter bag and remove the filter bag, take out the waste and rinse it.

WARNING

DO NOT using the brush or sharp objects to cleaning the filter bag, and DO NOT scrub the bag against itself while rinsing it, otherwise, the cleaner and filter bag will be damaged.

Storage

1. Switch the pool cleaner off, After extended periods of storage, it may be necessary to charge and discharge the battery pack several times to obtain maximum performance.

2. Clean the pool cleaner and re-pack to original package.
3. Store the pool cleaner and its accessories in a dark, dry, frost-free, well-ventilated place.
4. Always store the pool cleaner in a place that is inaccessible to children. The ideal storage temperature is between 10°C and 30°C.
5. We recommend using the original package for storage or covering the pool cleaner with a suitable cloth or enclosure to protect it against dust.

Transportation

1. Switch the product off.
2. Re-pack to original package.
3. Protect the product from any heavy impact or strong vibrations which may occur during transportation in vehicles.
4. Secure the product to prevent it from slipping or falling over.

Guarantee

Guarantee

Dear Customer,

This equipment is provided with a 1-year guarantee from the date of purchase. In case of defects, you have statutory rights against the seller of the product. These statutory rights are not restricted by our guarantee presented below. Terms of Guarantee the term of the guarantee begins on the date of purchase, please retain the original receipt and it's

required as proof of purchase. If a material or manufacturing defect occurs within 1-year of the date of the purchasing, we will repair or replace the product for you free of charge. This guarantee requires the defective equipment and proof of purchase to be presented within the 1-year period with a brief written description of what constitutes the defect and when it occurred. If the defect is covered by our guarantee, you will receive either the repaired product or a new product. No new guarantee period begins on repair or replacement of the product.

Guarantee Period And Statutory Claims For Defects

The guarantee period is not extended by the guarantee service. This also applies for replaced or repaired parts. Any damages and defects already present at the time of purchase must be reported immediately after unpacking.