

ENHULK

58V Max PRO SERIES 16Inch Brushless String Trimmer
LGT1216
LGT1216CF

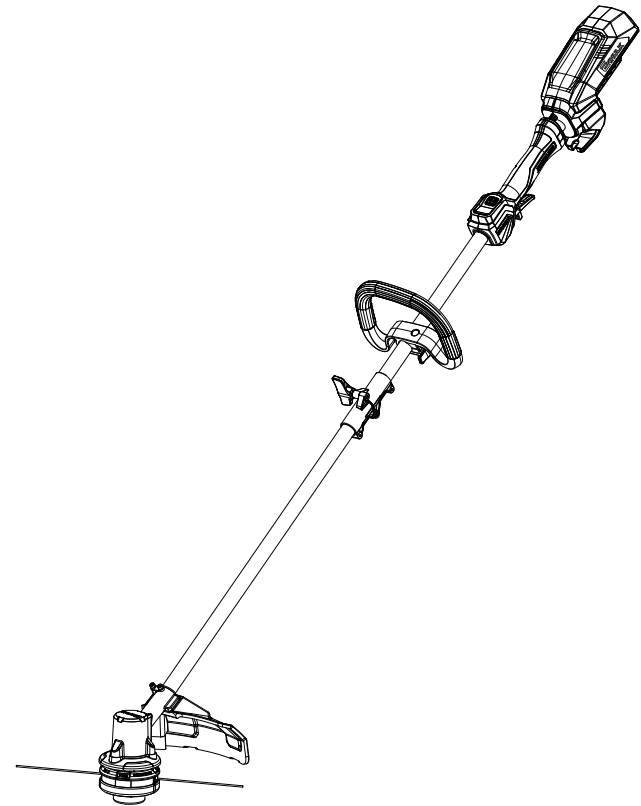

Scan the QR code
to watch the How-To
videos



SYVIO TECHNOLOGY.CO.LIMITED
ROOM A,8/F,wok Cheung Building,635-637
Shanghai Street,Mong kok,Hong Kong
Made in China

☎ 1 (877) 750-3787 (Mon.- Fri.9 to 5 PST)

✉ service@enhulktools.com

🏠 <http://www.enhulktools.com>

📘 @enhulkofficial

📷 @enhulkofficial

▶ @Enhulkofficial



Please Read Carefully Before Use
Original Instruction Manual

General Power Tool Safety Warnings

⚠ WARNING Read all safety warnings, instructions, illustrations and specifications provided with this power tool. Failure to follow all instructions listed below may result in electric shock, fire and/or serious injury. **Save all warnings and instructions for future reference.** The term "power tool" in the warnings refers to your mainsoperated (corded) power tool or battery-operated (cordless) power tool.

Work area safety

- **Keep work area clean and well lit.** Cluttered or dark areas invite accidents.
- **Do not operate power tools in explosive atmospheres, such as in the presence of flammable liquids, gases or dust.** Power tools create sparks which may ignite the dust or fumes.
- **Keep children and bystanders away while operating a power tool.** Distractions can cause you to lose control.

Electrical Safety

- **Power tool plugs must match the outlet. Never modify the plug in any way. Do not use any adapter plugs with earthed (grounded) power tools.** Unmodified plugs and matching outlets will reduce risk of electric shock.
- **Avoid body contact with earthed or grounded surfaces, such as pipes, radiators, ranges and refrigerators.** There is an increased risk of electric shock if your body is earthed or grounded.
- **Do not expose power tools to rain or wet conditions.** Water entering a power tool will increase the risk of electric shock.
- **Do not abuse the cord. Never use the cord for carrying, pulling or unplugging the power tool. Keep cord away from heat, oil, sharp edges or moving parts.** Damaged or entangled cords increase the risk of electric shock..
- **When operating a power tool outdoors, use an extension cord suitable for outdoor use.** Use of a cord suitable for outdoor use reduces the risk of electric shock.
- **If operating a power tool in a damp location is unavoidable, use a residual current device (RCD) protected supply.** Use of an RCD reduces the risk of electric shock.

Personal Safety

- **Stay alert, watch what you are doing and use common sense when operating a power tool. Do not use a power tool while you are tired or under the influence of drugs, alcohol or medication. A moment of inattention while operating power tools may result in serious personal injury.**

- **Use personal protective equipment. Always wear eye protection.** Protective equipment such as a dust mask, nonskid safety shoes, hard hat or hearing protection used for appropriate conditions will reduce personal injuries.
- **Prevent unintentional starting. Ensure the switch is in the off-position before connecting to power source and/or battery pack, picking up or carrying the tool.** Carrying power tools with your finger on the switch or energising power tools that have the switch on invites accidents.
- **Remove any adjusting key or wrench before turning the power tool on.** A wrench or a key left attached to a rotating part of the power tool may result in personal injury.
- **Do not overreach. Keep proper footing and balance at all times.** This enables better control of the power tool in unexpected situations.
- **Dress properly. Do not wear loose clothing or jewellery. Keep your hair and clothing away from moving parts.** Loose clothes, jewellery or long hair can be caught in moving parts.
- **If devices are provided for the connection of dust extraction and collection facilities, ensure these are connected and properly used.** Use of dust collection can reduce dust related hazards.
- **Do not let familiarity gained from frequent use of tools allow you to become complacent and ignore tool safety principles.** A careless action can cause severe injury within a fraction of a second.

Battery Tool Use And Care

- **Recharge only with the charger specified by the manufacturer.** A charger that is suitable for one type of battery pack may create a risk of fire when used with another battery pack.
- **Use power tools only with specifically designated battery packs.** Use of any other battery packs may create a risk of injury and fire.
- **When battery pack is not in use, keep it away from other metal objects, like paper clips, coins, keys, nails, screws or other small metal objects, that can make a connection from one terminal to another.** Shorting the battery terminals together may cause burns or a fire.
- **Under abusive conditions, liquid may be ejected from the battery; avoid contact. If contact accidentally occurs, flush with water. If liquid contacts eyes, additionally seek medical help.** Liquid ejected from the battery may cause irritation or burns.
- **Do not use a battery pack or tool that is damaged or modified.** Damaged or modified batteries may exhibit unpredictable behaviour resulting in fire, explosion or risk of injury.
- **Do not expose a battery pack or tool to fire or excessive temperature.** Exposure to fire or temperature above 130°C may cause explosion.

Safety Instructions

- **Follow all charging instructions and do not charge the battery pack or tool outside the temperature range specified in the instructions.** Charging improperly or at temperatures outside the specified range may damage the battery and increase the risk of fire.

Service

- **Have your power tool serviced by a qualified repair person using only identical replacement parts.** This will ensure that the safety of the power tool is maintained.
- **Never service damaged battery packs.** Service of battery packs should only be performed by the manufacturer or authorized service providers.

Grass Trimmer Safety Warnings

- **Do not use the machine in bad weather conditions, especially when there is a risk of lightning.** This decreases the risk of being struck by lightning.
- **Thoroughly inspect the area for wildlife where the machine is to be used.** Wildlife may be injured by the machine during operation.
- **Thoroughly inspect the area where the machine is to be used and remove all stones, sticks, wires, bones, and other foreign objects.** Thrown objects can cause personal injury.
- **Before using the machine, always visually inspect to see that the cutter or blade and the cutter or blade assembly are not damaged.** Damaged parts increase the risk of injury.
- **Follow instructions for changing accessories.** Improperly tightened blade securing nuts or bolts may either damage the blade or result in it becoming detached.
- **Wear eye, ear, head and hand protection.** Adequate protective equipment will reduce personal injury by flying debris or accidental contact with the cutting line or blade.
- **While operating the machine, always wear long trousers.** Exposed skin increases the likelihood of injury from thrown objects.
- **Keep bystanders away while operating the machine.** Thrown debris can result in serious personal injury.
- **Always use two hands when operating the machine.** Holding the machine with both hands will avoid loss of control.
- **Hold the machine by the insulated gripping surfaces only, because the cutting line or blade may contact hidden wiring.** Cutting line or blades contacting a "live" wire may make exposed metal parts of the machine "live" and could give the operator an electric shock.
- **Always keep proper footing and operate the machine only when standing on the ground.** Slippery or unstable surfaces may cause a loss of balance or control of the machine.
- **Do not operate the machine on excessively steep slopes.** This reduces the risk of loss of control, slipping and falling which may result in personal injury.

- **When working on slopes, always be sure of your footing, always work across the face of slopes, never up or down and exercise extreme caution when changing direction.** This reduces the risk of loss of control, slipping and falling which may result in personal injury.
- **Keep all parts of the body away from the cutter, line or blade when the machine is operating.** Before you start the machine, make sure the cutter, line or blade is not contacting anything. A moment of inattention while operating the machine may result in injury to yourself or others.
- **Do not operate the machine above waist height.** This helps prevent unintended cutter or blade contact and enables better control of the machine in unexpected situations.
- **When cutting brush or saplings that are under tension, be alert for spring back.** When the tension in the wood fibres is released, the brush or sapling may strike the operator and/or throw the machine out of control.
- **Use extreme caution when cutting brush and saplings.** The slender material may catch the blade and be whipped toward you or pull you off balance.
- **Maintain control of the machine and do not touch cutters, lines or blades and other hazardous moving parts while they are still in motion.** This reduces the risk of injury from moving parts.
- **Carry the machine with the machine switched off and away from your body.** Proper handling of the machine will reduce the likelihood of accidental contact with a moving cutter, line or blade.
- **When clearing jammed material or servicing the machine, make sure the switch is off and the battery pack is removed.** Unexpected starting of the machine while clearing jammed material or servicing may result in serious personal injury.
- **Only use replacement cutters, lines, cutting heads and blades specified by the manufacturer.** Incorrect replacement parts may increase the risk of breakage and injury.

WARNING

When using the product the safety rules must be followed. For your own safety and that of bystanders please read these instructions before operating the product. Please keep the instructions safe for later use.

Training

- **Read the instructions carefully.** Be familiar with the controls and the proper use of the product.
- **Never allow children, persons with reduced physical, sensory or mental capabilities or lack of experience and knowledge or people unfamiliar with these instructions to use the machine, local regulations may restrict the age of the operator.**
- **Keep in mind that the operator or user is responsible for accidents or hazards occurring to other people or their property.**

Safety Instructions

Preparation

- Never operate the product while people, especially children, or pets are nearby.
- Wear eye protection and stout shoes and long trousers at all times while operating the product.
- Before use, always visually inspect the machine for damaged, missing or misplaced guards or shields.

Operation



- Avoid using the machine in bad weather conditions especially when there is a risk of lightning.
- Use the product only in daylight or good artificial light.
- Never operate the product with damaged guards or shields or without guards or shields in place.
- Switch on the motor only when the hands and feet are away from the cutting means.
- Before using the product and after any impact, check for signs of wear or damage and repair as necessary.
- Always disconnect the product from the power supply (i. e. remove the plug from the power supply or the battery pack)
 - whenever leaving the product unattended,

- before clearing a blockage,
- before checking, cleaning or working on the product,
- after striking a foreign object,
- whenever the product starts vibrating abnormally.
- Take care against injury to feet and hands from the cutting device.
- Always ensure that the air vents are kept clear of debris.
- Take care against injury from any device fitted for trimming the filament line length, if applicable.
- After extending new cutter line always return the product to its normal operating position before switching on.
- Never fit metal cutting elements.
- **Never use replacement parts or accessories not provided or recommended by the manufacturer.** Do not overreach and to keep the balance at all times, always be sure of the footing on slopes and to walk, never run.
- Do not to touch moving hazardous parts before the battery pack is removed and the moving hazardous parts have come to a complete stop.

Symbols

Some of the following symbols may be used on this product. Please study them and learn their meaning. Proper interpretation of these symbols will allow you to operate the product be

	Indicates a potential personal injury hazard.
	To reduce the risk of injury, user must read and understand operator's manual before using this product.
	Risk of fire and burns. Do not expose battery, battery compartment, or electronic components to rain, water, or liquids. Do not operate on wet ground.
	Always wear safety goggles or safety glasses with side shields when operating this product that comply with ANSI Z87.1
	Do not install or use any type of blade on a product displaying this symbol.
	Thrown objects can ricochet and result in personal injury or property damage.

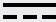
	Keep all bystanders at least 50 ft. away.
	To reduce the risk of injury, user must remove the battery prior to performing service or maintenance on the product.
	Type or a characteristic of current
n _o	Maximum speed
RPM	Rotational speed
V	Voltage
Hz	Frequency (cycles per second)
min	Time

Product Descriptions And Specifications

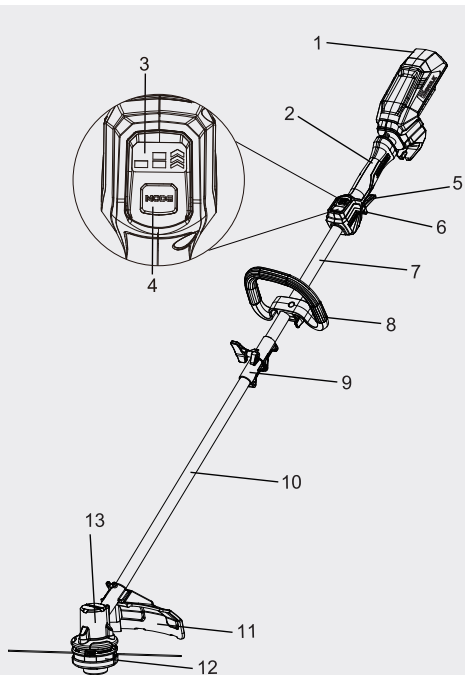

1. Battery Release Button
2. Rear Handle
3. LED Panel Indicator
4. Speed Mode Switch
5. Variable Speed Trigger
6. Lock-out Button
7. Upper Shaft
8. Quick Adjustable Front Handle
9. Tool-less Aluminum Foldable Hinge
10. Lower Shaft
11. Safety Guard
12. Trimmer Head
13. Motor Housing

Assembly And Adjustment

WARNING

Before assembly make sure that the appliance is switched off and the battery has been removed.

Technical Data

58V Max PRO SERIES 16 Inch Brushless String Trimmer

Article number	LGT1216	LGT1216CF
Voltage	58V Max	
Nominal Voltage	50.4V	
No-load speed	ECO mode: 0-4800 RPM HIGH mode: 0-5800 RPM TURBO mode: 0-6300 RPM	
Cutting Width	16 in. (40 cm)	
Cutting Line Diameter	0.095 in. (2.4 mm) Optional 0.080 in. (2mm)	
Line Feed	Bump feed	
Shaft Type	Aluminum	Carbon Fiber
Net Weight (Without battery)	7.05 lbs. (3.2 kg)	6.83 lbs. (3.1 kg)
Battery	LBA1025 (2.5Ah)	LBA1050 (5.0Ah)
Charger	LCH1025	
Recommended Using Temperature	5°F-104°F (-15°C-40°C)	
Recommended Charing Temperature	32°F-122°F (0°C-50°C)	

Operating Instructions

Unfolding The Shaft

⚠ WARNING

In order to avoid pinching your hands or fingers, do not hold the shaft at the joint. Remove the battery pack. Do not attempt to start the trimmer until the shaft has been locked.

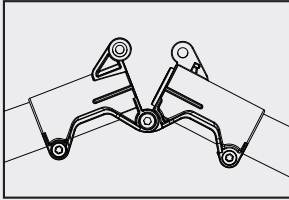

- A. Put your trimmer on the ground or the floor and make sure that the cable is inside the shaft, so that it will not be pinched when closing the hinge. Carefully unfold the shaft until the two holes in the hinge are accurately aligned.

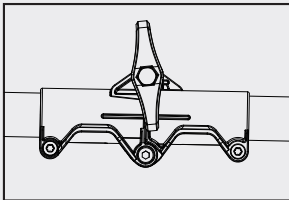

- B. Tighten the tool-less bolt to lock the shaft in place.

Mounting The Guard

⚠ WARNING

Always wear gloves when mounting or replacing the guard. Be careful of the blade on the guard and protect your hands from being injured by the blade. Remove the battery pack.

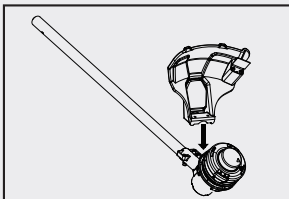

- A. Lay the trimmer on the ground or the floor with the trimmer head facing upward.

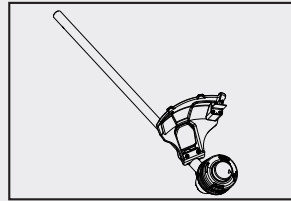

- B. Align the two screws, which are preassembled on the guard, with the two screw holes in the shaft and then tighten them with the supplied star key.

Mounting And Adjusting The Front Handle

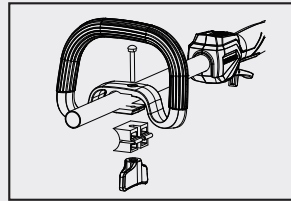

- A. Remove the knob from the handle.
B. Attach the auxiliary handle and lower clamp on the shaft.
C. Set the auxiliary handle in the comfortable position.
D. Put the bolt through the holes.
E. Tighten the auxiliary handle with the knob.

Operation

⚠ WARNING

Always Use Proper Eye Protection That Conforms To ANSI Z87.1 (CAN/CSA Z94.3) While Operating This Appliance.

Caution

Before you begin trimming, only use the recommend type of cutting line.

To Install/remove Battery Pack

⚠ WARNING

Always remove the battery pack from the product when you are assembling parts, making adjustments, cleaning, or when it is not in use. Removing the battery pack will prevent accidental starting that could cause serious personal injury.

NOTE: Fully charge the battery pack before first use.

Operating Instructions

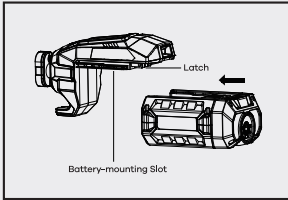

To install battery pack

- Align the ribs of the battery pack with the battery-mounting slots in the string trimmer.
- Slide the battery pack in until it snaps into position.

To remove battery pack

WARNING

Always be aware of the location of your feet and children or pets around you when pressing the battery release button. NEVER remove the battery pack at a high position. Serious injury could result if the battery pack falls.

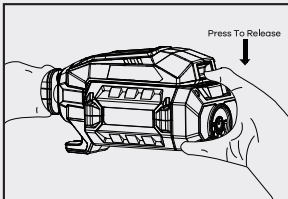

- Hold the battery pack in the palm of your hand.
- Press the battery-release button with your thumb; the battery pack will disengage from the latch.
- Grasp the battery pack and remove it from the string trimmer.

Starting The String Trimmer

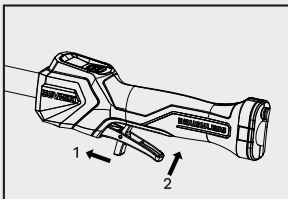

- Move the lock-off switch forward(1) and then press the variable speed trigger(2). The string trimmer will start.

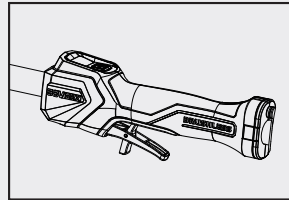

- The rotational speed of the trimmer head is controlled with the variable speed trigger. More pressure on the trigger results in higher speed; less pressure on the trigger results in lower speed. Adjust the speed to suit the task by hand.

NOTICE: The motor starts only when the lock-off switch is moved forward and the variable speed trigger is depressed at the same time.

Stopping the string trimmer

Move the string trimmer away from the cutting area and release the variable speed trigger to stop the tool.

WARNING

Always remove the battery pack from the string trimmer during work breaks and after finishing work.

Speed Adjustment Function

The string trimmer has three speed settings, ECO/ HIGH/ TURBO mode. Press the speed switch to change cutting speed between the ECO, HIGH and TURBO. The speed indicator will display the active speed status.

Adjust The Length Of The Cutting Line

While you operate the machine, the cutting line gets worn shorter. You can adjust the length of the cutting line.

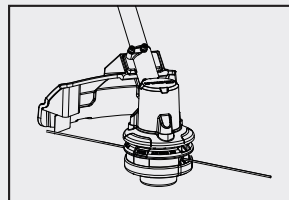

- While the trimmer is running, bump the trimmer head against the ground.
- Line is automatically released and the cut-off blade cuts the excess length.

Cutting Tips

Cutting Tips

- Tilt the machine toward the area to be cut. Use the tip of the cutting line to cut grass.
- Move the machine from right to left to prevent thrown debris from hitting the operator.
- Do not cut in the danger area.
- Do not force the trimmer head into uncut grass.
- Wire and picket fences cause cutting line wear and breakage. Stone and brick walls, curbs, and wood can wear the cutting line quickly.

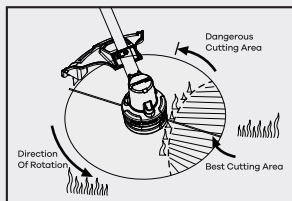

Use only the replacement parts and accessories of the initial manufacturer.

Remove Cutting Line

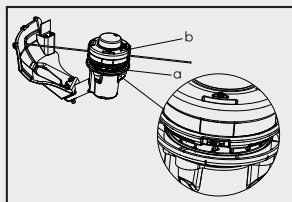

1. Push the tabs (a) on the sides of the trimmer head at the same time.
2. Pull and remove the spool cover (b).
3. Remove any remaining cutting line.
4. Clean dirt and debris from all parts. Replace spool if it is worn or damaged.
5. Align the trimmer head tabs (a) with the spool cover openings.
6. Push the spool cover until it clicks into position.

Replace Cutting Line

Do not put more than 11 feet of cutting line in at a time.

1. Remove the remaining cutting line on the spool.
2. Line up the arrow (c) on the spool cover with the arrow (d) on the trimmer head.

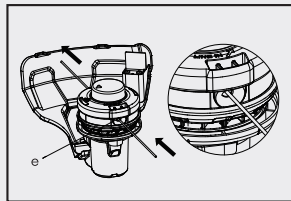
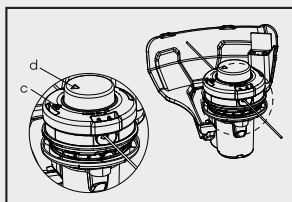

3. Insert the cutting line into the mounting hole (e). Push the cutting line until it exits from the opposite hole.
4. Pull the cutting line through until there is an equal quantity of cutting line on each side.
5. **Push and rotate the spool cover clockwise in the arrow direction to wind the cutting line into the trimmer head.** Keep approximately 5 in of cutting line above out of each side of the trimmer head.

Replace The Spool

If any parts of the spool retainer assembly are damaged or worn, replace the damaged part and reassemble them as following showing.

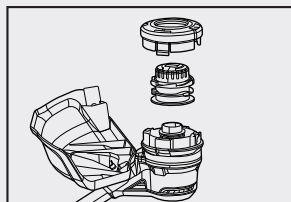

1. Push the tabs on the sides of the trimmer head at the same time.
2. Pull and remove the spool cover.
3. Replace the original spool with a new spool.
4. Push the spool cover until it clicks into position.
5. Refit the cutting line to the trimmer head.

The Indicator Display

The indicator will display the speed mode and machine status:

LED Indicators	LED Indicator Display	Machine Status
	Eco LED Solid Green	Eco Mode
	High LED Solid Green	High Mode
	Turbo LED Solid Green	Turbo Mode
	Current LED Solid Red	Low Battery Capacity
	Current LED Flashing Red	Trouble

Troubleshooting

Problem	Possible causes	Solution
Motor fails to start when trigger switch is depressed	Battery is not secure	To secure the battery pack, make sure the latches on the top of the battery pack snap into place.
	Battery is low power	Charge the battery pack according to the instructions.
Motor runs, but cutting line do not move	Trimmer damaged Do not use string trimmer	Contact technical service
Trimmer smokes during operation	Trimmer damaged Do not use string trimmer	Contact technical service
Cutting line does not advance	Line may be tangled on spool	Remove battery, remove spool cover and spool. unwind spool and rewind, ensuring that line is not tangled.
	Line has run out	Replace spool or spool line.

Maintenance and transportation

Cleaning And Maintenance

WARNING

All maintenance should be carried out by a qualified person, do not try to repair any defect. When servicing, use only identical replacement parts. Use of any other part could create a hazard or cause product damage.

Cleaning

1. Remove the battery pack.
2. **Brush or blow dust and debris out of the air vents using compressed air or a vacuum.** Keep the air vents free of obstructions, sawdust, and wood chips. Do not spray, wash, or immerse the air vents in water.
3. **Wipe off the housing and the plastic components using a moist, soft cloth.** Do not use strong solvents or detergents on the plastic housing or plastic components. Certain household cleaners may cause damage, and may cause a shock hazard.

Storage

1. Switch the product off and remove the battery packs.
2. Clean the product and re-pack to original package.
3. Store the product and its accessories in a dark, dry, frost-free, well-ventilated place.
4. **Always store the product in a place that is inaccessible to children.** The ideal storage temperature is between 64°F-75°F(18 °C-24 °C).
5. We recommend using the original package for storage or covering the product with a suitable cloth or enclosure to protect it against dust.

Transportation

1. Switch the product off and remove the battery packs.
2. Re-pack to original package.
3. **Protect the product from any heavy impact or strong vibrations which may occur during transportation in vehicles.**
4. Secure the product to prevent it from slipping or falling over.

Guarantee

Guarantee

Dear Customer,

This equipment is provided with a 4-year guarantee from the date of purchase. In case of defects, you have statutory rights against the seller of the product. These statutory rights are not restricted by our guarantee presented below. Terms of Guarantee the term of the guarantee begins on the date of purchase, please retain the original receipt and it's required as proof of purchase. If a material or manufacturing defect occurs within 4-year of the date of the purchasing, we will repair or replace the product for you free of charge. This guarantee requires the defective equipment and proof of purchase to be presented within the 4-year period with a brief written description of what constitutes the defect and when it occurred. If the defect is covered by our guarantee, you will receive either the repaired product or a new product. No new guarantee period begins on repair or replacement of the product.

Guarantee Period And Statutory Claims For Defects

The guarantee period is not extended by the guarantee service. This also applies for replaced or repaired parts. Any damages and defects already present at the time of purchase must be reported immediately after unpacking.