

ENHULK

20V String Trimmer
DS164

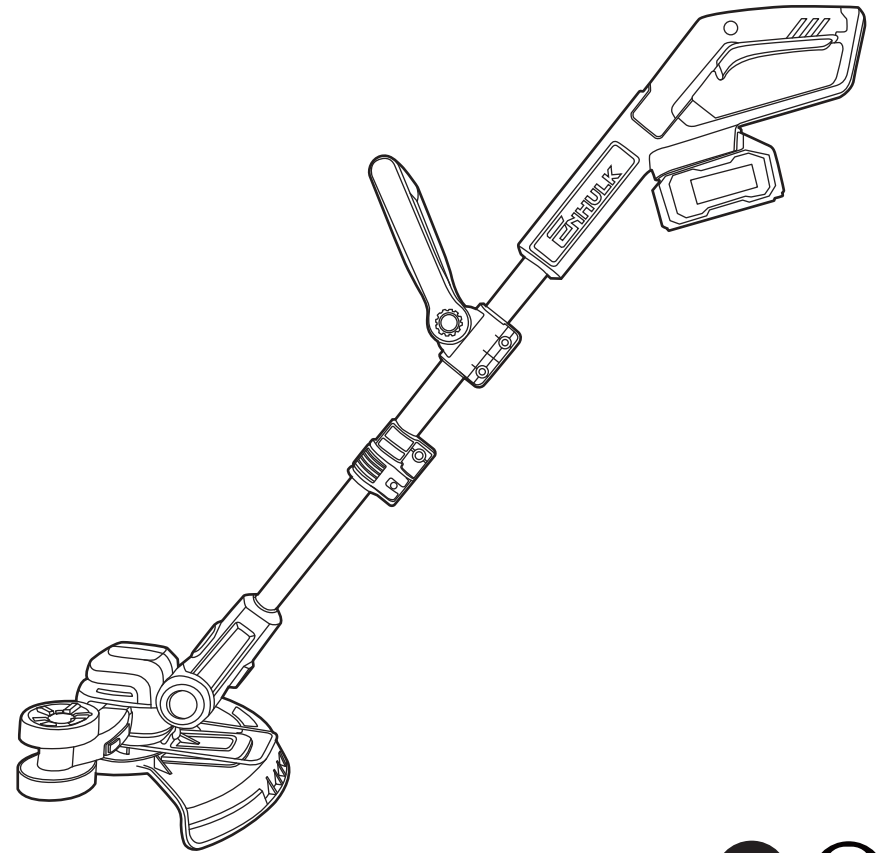

SYVIO TECHNOLOGY CO.,LIMITED

ROOM A,8/F,wok Cheung Building,635-637
Shanghai Street,Mong kok,Hong Kong
0086-133-2298-6467
service@enhulktools.com
Made in China



**Please Read Carefully Before Use
Original Instruction Manual**

SAFETY INSTRUCTIONS

General Power Tool Safety Warnings

⚠ WARNING! Read all safety warnings, instructions, illustrations and specifications provided with this power tool. Failure to follow all instructions listed below may result in electric shock, fire and/or serious injury.

Save all warnings and instructions for future reference. The term "power tool" in the warnings refers to your mainsoperated (corded) power tool or battery-operated (cordless) power tool.

- **Work area safety**
- **Keep work area clean and well lit.** Cluttered or dark areas invite accidents.
- **Do not operate power tools in explosive atmospheres, such as in the presence of flammable liquids, gases or dust.** Power tools create sparks which may ignite the dust or fumes.
- **Keep children and bystanders away while operating a power tool.** Distractions can cause you to lose control.

Electrical Safety

Power tool plugs must match the outlet. Never modify the plug in any way. Do not use any adapter plugs with earthed (grounded) power tools. Unmodified plugs and matching outlets will reduce risk of electric shock.

- **Avoid body contact with earthed or grounded surfaces, such as pipes, radiators, ranges and refrigerators.** There is an increased risk of electric shock if your body is earthed or grounded.
- **Do not expose power tools to rain or wet conditions.** Water entering a power tool will increase the risk of electric shock.
- **Do not abuse the cord. Never use the cord for carrying, pulling or unplugging the power tool. Keep cord away from heat, oil, sharp edges or moving parts.** Damaged or entangled cords increase the risk of electric shock.
- **When operating a power tool outdoors, use an extension cord suitable for outdoor use.** Use of a cord suitable for outdoor use reduces the risk of electric shock.
- **If operating a power tool in a damp location is unavoidable, use a residual current device (RCD) protected supply.** Use of an RCD reduces the risk of electric shock.

Personal Safety

- **Stay alert, watch what you are doing and use common sense when operating a power tool. Do not use a power tool while you are tired or under the influence of drugs, alcohol or**

medication. A moment of inattention while operating power tools may result in serious personal injury.

- **Use personal protective equipment. Always wear eye protection.** Protective equipment such as a dust mask, nonskid safety shoes, hard hat or hearing protection used for appropriate conditions will reduce personal injuries.
- **Prevent unintentional starting. Ensure the switch is in the off-position before connecting to power source and/or battery pack, picking up or carrying the tool.** Carrying power tools with your finger on the switch or energising power tools that have the switch on invites accidents.
- **Remove any adjusting key or wrench before turning the power tool on.** A wrench or a key left attached to a rotating part of the power tool may result in personal injury.
- **Do not overreach. Keep proper footing and balance at all times.** This enables better control of the power tool in unexpected situations.
- **Dress properly. Do not wear loose clothing or jewellery. Keep your hair and clothing away from moving parts.** Loose clothes, jewellery or long hair can be caught in moving parts.
- **If devices are provided for the connection of dust ex- traction and collection facilities, ensure these are connected and properly used.** Use of dust collection can reduce dust related hazards.
- **Do not let familiarity gained from frequent use of tools allow you to become complacent and ignore tool safety principles.** A careless action can cause severe injury within a fraction of a second.

Power Tool Use And Care

- **Do not force the power tool. Use the correct power tool for your application.** The correct power tool will do the job better and safer at the rate for which it was designed.
- **Do not use the power tool if the switch does not turn it on and off.** Any power tool that cannot be controlled with the switch is dangerous and must be repaired.
- **Disconnect the plug from the power source and/or remove the battery pack, if detachable, from the power tool before making any adjustments, changing accessories, or storing power tools.** Such preventive safety measures reduce the risk of starting the power tool accidentally.
- **Store idle power tools out of the reach of children and do not allow persons unfamiliar with the power tool or these instructions to operate the power tool.** Power tools are dangerous in the hands of untrained users.
- **Maintain power tools and accessories. Check for mis- alignment or binding of moving parts, breakage of parts and any other condition that may affect the power tool's operation. If**

Safety Instruction

damaged, have the power tool repaired before use. Many accidents are caused by poorly maintained power tools.

- **Keep cutting tools sharp and clean.** Properly maintained cutting tools with sharp cutting edges are less likely to bind and are easier to control.
- **Use the power tool, accessories and tool bits etc. in accordance with these instructions, taking into account the working conditions and the work to be performed.** Use of the power tool for operations different from those intended could result in a hazardous situation.
- **Keep handles and grasping surfaces dry, clean and free from oil and grease.** Slippery handles and grasping surfaces do not allow for safe handling and control of the tool in unexpected situations.

Battery Tool Use And Care

- **Recharge only with the charger specified by the manufacturer.** A charger that is suitable for one type of battery pack may create a risk of fire when used with another battery pack.
- **Use power tools only with specifically designated battery packs.** Use of any other battery packs may create a risk of injury and fire.
- **When battery pack is not in use, keep it away from other metal objects, like paper clips, coins, keys, nails, screws or other small metal objects, that can make a connection from one terminal to another.** Shorting the battery terminals together may cause burns or a fire.
- **Under abusive conditions, liquid may be ejected from the battery; avoid contact. If contact accidentally occurs, flush with water. If liquid contacts eyes, additionally seek medical help.** Liquid ejected from the battery may cause irritation or burns.
- **Do not use a battery pack or tool that is damaged or modified.** Damaged or modified batteries may exhibit unpredictable behaviour resulting in fire, explosion or risk of injury.
- **Do not expose a battery pack or tool to fire or excessive temperature.** Exposure to fire or temperature above 130°C may cause explosion.
- **Follow all charging instructions and do not charge the battery pack or tool outside the temperature range specified in the instructions.**

Charging improperly or at temperatures outside the specified range may damage the battery and increase the risk of fire.

Service

- **Have your power tool serviced by a qualified repair person using only identical replacement parts.** This will ensure that the safety of the power tool is maintained.
- **Never service damaged battery packs.** Service of battery packs should only be performed by the manufacturer or authorized service providers.

Electrically Powered String Trimmer Safety Warnings Important Read Carefully Before Use Keep For Future Reference

WARNING!

When using the product the safety rules must be followed. For your own safety and that of bystanders please read these instructions before operating the product. Please keep the instructions safe for later use.

Training

- Read the instructions carefully. Be familiar with the controls and the proper use of the product.
- Never allow children, persons with reduced physical, sensory or mental capabilities or lack of experience and knowledge or people unfamiliar with these instructions to use the machine, local regulations may restrict the age of the operator.
- Keep in mind that the operator or user is responsible for accidents or hazards occurring to other people or their property.

Preparation

- Never operate the product while people, especially children, or pets are nearby.
- Wear eye protection and stout shoes and long trousers at all times while operating the product.
- Before use, always visually inspect the machine for damaged, missing or misplaced guards or shields.

Operation

- Avoid using the machine in bad weather conditions especially when there is a risk of lightning.
- Use the product only in daylight or good artificial light.
- Never operate the product with damaged

Safety Instruction



guards or shields or without guards or shields in place.

- Switch on the motor only when the hands and feet are away from the cutting means.
- Before using the product and after any impact, check for signs of wear or damage and repair as necessary.
- Always disconnect the product from the power supply (i. e. remove the plug from the power supply or the battery pack)
 - whenever leaving the product unattended;
 - before clearing a blockage;
 - before checking, cleaning or working on the product;
 - after striking a foreign object;
 - whenever the product starts vibrating abnormally.
- Take care against injury to feet and hands from the cutting device.

- Always ensure that the air vents are kept clear of debris.
- Take care against injury from any device fitted for trimming the filament line length, if applicable.
- After extending new cutter line always return the product to its normal operating position before switching on.
- Never fit metal cutting elements.
- Never use replacement parts or accessories not provided or recommended by the manufacturer. Do not overreach and to keep the balance at all times, always be sure of the footing on slopes and to walk, never run.
- Do not to touch moving hazardous parts before the battery pack is removed and the moving hazardous parts have come to a complete stop.

Symbols

| | |
|---|---|
|  | <p>Read the operator's manual</p> |
|  | <p>Always use eye/ear protection, Wear dust mask and safety helmet.</p> |
|  | <p>Do not expose to rain</p> |
|  | <p>Do not dispose of waste batteries as unsorted municipal waste.</p> |

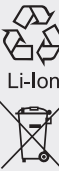
| | |
|---|--|
|  | <p>Do not burn</p> |
|  | <p>Keep all other people, including children, pets and bystanders outside the 15 meters hazard zone, stop the trimmer immediately if you are approached.</p> |
|  | <p>Li-Ion battery This product has been marked with a symbol relating to 'separate collection' for all battery packs and battery pack. It will then be recycled or dismantled in order to reduce the impact on the environment. Battery packs can be hazardous for the environment and for human health since they contain hazardous substances.</p> |

Product Description

Product Features

Diagram of the power tool on the graphics page.

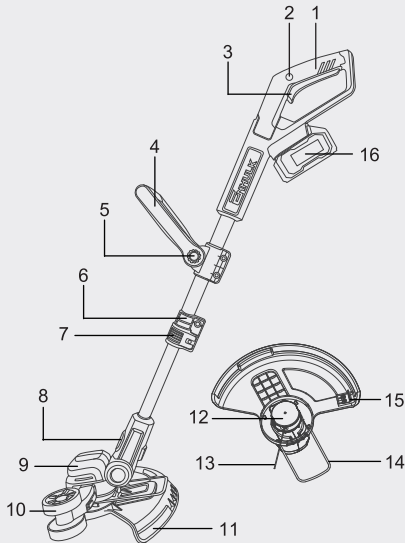

- (1) Handle
- (2) Anti Lock-out Button
- (3) Trigger Switch
- (4) Auxiliary Handle
- (5) Handle Unlock Button

- (6) Locking Collar
- (7) Height-Locking Clamp
- (8) Edge Adjust Button
- (9) Trimmer Head
- (10) Edger Wheel
- (11) Guard
- (12) Spool Housing
- (13) Line
- (14) Guide
- (15) Line Cutter
- (16) Battery

Technical Data

Cordless String Trimmer

| | |
|----------------------------------|----------|
| Article number | DS164 |
| Voltage | DC 20V |
| Cutting Width | 10"/12" |
| No-load Speed | 8000rpm |
| String Line Type | 0.065" |
| Guaranteed sound power level LwA | 88dB (A) |

Operating Instructings

Assembly And Adjustment

⚠ WARNING!

Before assembly make sure that the appliance is switched off and the battery has been removed.

Assembly tools required (Not supplied):

- Phillips screwdriver.

Installing The Guard

NOTE: Install the protective guard before operating the string trimmer. It can not be removed or disassembled.

1. Remove the battery pack.
2. Tighten the string trimmer to access the trimmer head.
3. Place the guard (11) on to the trimmer head and Align the screw hole on the guard with the screw hole on the trimmer head.

Operating Instructing

4. Insert the screw into the trimmer head, fastening the guard in place.
5. Once the guard is installed, remove the covering on the line cutter (15), located on the edge of the guard.

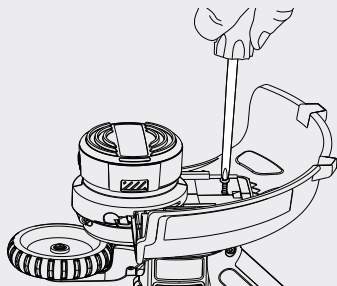

Installing The Edger Wheel

Press the lock button and position edger wheel into the portion of the trimmer head until locked into position.

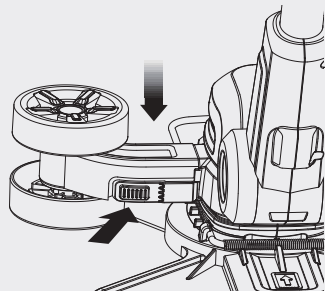

Adjusting The Auxiliary Handle

To adjust the auxiliary handle (4) up or down, press on the handle unlock button (5) and raise or lower the auxiliary handle (4). The auxiliary handle should be adjusted so that your front arm is straight when the trimmer is in the working position.

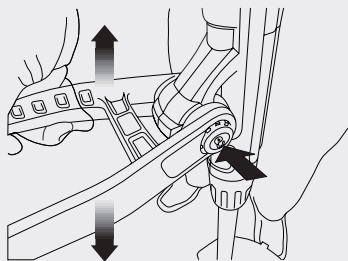

Adjust Telescopic Tube Height

1. Release the Height-Locking Clamp (7) on the tube.
2. Adjust telescopic tube height is necessary for your work comfortable.

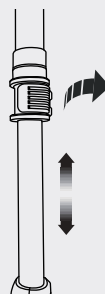

Operation

⚠ WARNING!

Always Use Proper Eye Protection That Conforms To ANSI Z87.1 (CAN/CSA Z94.3) While Operating This Appliance.

⚠ WARNING!

Remove the battery before making any assembly, adjustments, or changing accessories. Such preventive safety measures reduce the risk of starting the trimmer accidentally.

⚠ CAUTION

Before you begin trimming, only use the recommend type of cutting line.

Operating Instructing

⚠ CAUTION

Inspect area to be trimmed and remove any wire, cord, or string-like objects which could become entangled in the rotating line or spool. Be particularly careful to avoid any wire which might be bent outwardly into the path of the appliance, such as barbs at the base of a chain link fence.

Switching On And Off

To switch the appliance on, press the anti lock-out button (2), and squeeze the trigger switch(3).

To switch the appliance off, release the trigger switch(3).

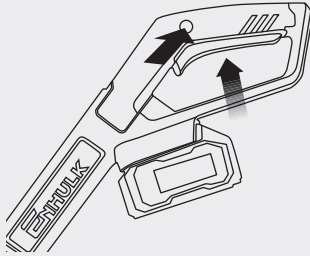

Operating The Trimmer

With the unit on, angle unit and slowly swing the trimmer side to side. Maintain a cutting angle of 5° to 10°. Do not exceed 10°. Cut with the tip of the line. To keep distance from hard surfaces use guide (14).

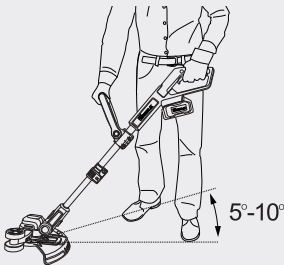

Maintain a minimum distance of 24 inches between the guard and your feet. To achieve this distance adjust the overall height of the trimmer.

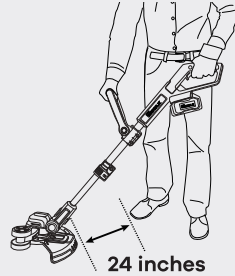

Convert To Edging Mode

⚠ CAUTION

The wheeled edge guide should only be used when in the edging mode. The trimmer can be used in trimming mode or edging mode to trim overhanging grass along lawn edges and flower beds.

Maintain a minimum distance of 24 inches between the guard and your feet. To achieve this distance adjust the overall height of the trimmer.

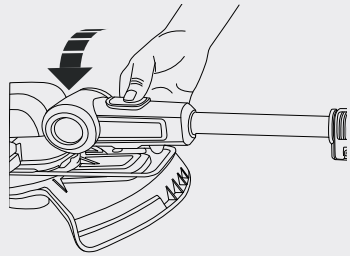

Adjust Trimmer Head angle

Gently step on the trimmer head (9) with your foot and raise or lower the tube to adjust trimmer head angle.

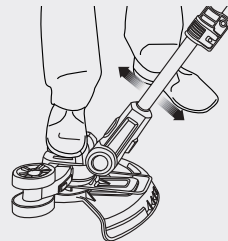

Operating Instructing

Adjust The Cutting Width

Invert the string trimmer head, use the phillips screwdriver to rotated line cutter (15) 180°, for change the cutting width from 10" to 12".

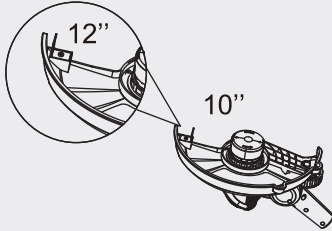

Edging

⚠ WARNING

When being used as an Edger, stones, pieces of metal and other objects can be thrown out at high speed by the line. The trimmer and guard are designed to reduce the danger. However, **MAKE SURE** that other persons and pets are at least 100 feet (30m) away. Optimum cutting results are achieved on edges deeper than 2 inches (50 mm)

Do not use this trimmer to create trenches. Using the edger wheel (10) to guide the trimmer. Position the edger wheel (10) on the edge of the sidewalk or abrasive surface so the cutting line is over the grass or dirt area to be edged. To make a closer cut, slightly tilt the trimmer.

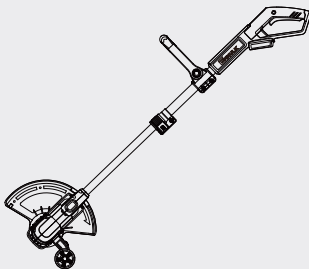

How To Use String Trimmer Safety

- Use the tip of the string to do the cutting, do not force string head into uncut grass. Use edge guide along such things as fences, houses and flower beds for best practices.

- Wire and picket fences cause extra string wear, even breakage. Stone and brick walls, curbs, and wood may wear string rapidly.
- Do not allow spool cap to drag on ground or other surfaces.
- In long growth cut from the top down and if the grass is higher than 6" (15 cm), trim in small stages.
- Keep trimmer tilted toward the area being cut, this is the best cutting area.
- The trimmer cuts when passing the unit from the right to left. This will avoid throwing debris at the operator.
- Avoid trees and shrubs. Tree bark, wood moldings, siding, and fence posts can easily be edging damaged by the string.

To Replace The Spool

1. Remove the battery pack.
2. Invert the string trimmer to access the trimmer head.
3. Press the release tabs on the line spool cap (b), and remove the cap by pulling it straight off.
4. Replace the spool (a) with a new pre-wound spool, Insert the end of line through the opening (d) in the spool housing (c).
5. Align the tabs on the spool cover with the slots in the spool housing on the trimmer head.
6. Push down on the spool cover locking it to the spool housing.
7. To advance the line when initially installed, you must pull the line while pressing the white line release button on the side of the spool housing (c).

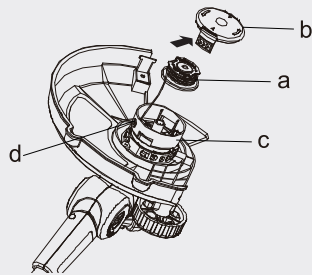

NOTE: Make sure that cover is fully positioned, listen for two audible clicks to ensure both lugs are correctly located. Power the appliance on. In a few seconds or less you'll hear the nylon line being cut automatically to the proper length.

Operating Instructing

Rewinding Spool From Bulk Line

NOTE: Use Only 0.065 In(1.65mm). Round Diameter Line.

Bulk line is also available for purchase from your local retailer. Hand wound spools from bulk line are likely to become tangled more frequently than factory wound spools. For best results, factory wound spools are recommended. To install bulk line, follow the steps below:

1. Remove battery from appliance.
2. Remove the empty spool from the appliance as described in **"To Replace The Spool"**.
3. Remove any remaining cutting line from the spool.
4. Make a fold at the end of the cutting line at about 3/4 inch (19mm)(e). Feed the cutting line into one of the line anchoring slots (f).

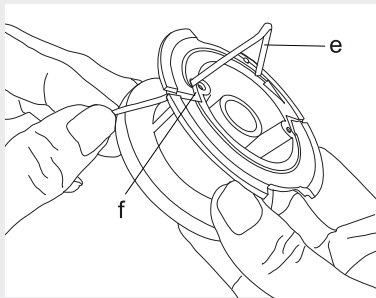

5. Insert the 3/4 inch (19mm) end of the bulk line into the hole (e) in the spool adjacent to the slot. Make sure the line is pulled tight against the spool.

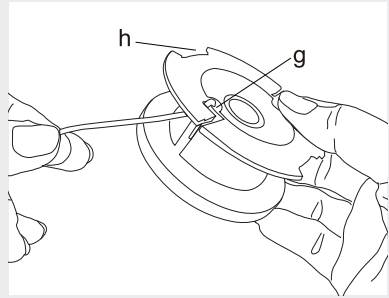

6. Wind the cutting line onto the spool in the direction of the arrow on the spool. Make sure to wind the line on neatly and in layers. **Do not crisscross.** When the wound cutting line reaches the recesses (h), cut the line.

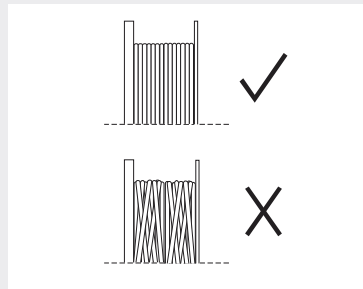

7. Fit the spool onto the appliance as described in **"To Replace The Spool"**.

Maintenance and transportation

Cleaning And Maintenance

⚠ WARNING

All maintenance should be carried out by a qualified person, do not try to repair any defect. When servicing, use only identical replacement parts. Use of any other part could create a hazard or cause product damage.

Cleaning

1. Remove the battery pack.
2. Brush or blow dust and debris out of the air vents using compressed air or a vacuum. Keep the air vents free of obstructions, sawdust, and wood chips. Do not spray, wash, or immerse the air vents in water.
3. Wipe off the housing and the plastic components using a moist, soft cloth. Do not use strong solvents or detergents on the plastic housing or plastic components. Certain household cleaners may cause damage, and may cause a shock hazard.

Storage

1. Switch the product off and remove the battery packs.
2. Clean the product and re-pack to original package.
3. Store the product and its accessories in a dark, dry, frost-free, well-ventilated place.
4. Always store the product in a place that is inaccessible to children. The ideal storage temperature is between 10°C and 30°C.
5. We recommend using the original package for storage or covering the product with a suitable cloth or enclosure to protect it against dust.

Transportation

1. Switch the product off and remove the battery packs.
2. Re-pack to original package.
3. Protect the product from any heavy impact or strong vibrations which may occur during transportation in vehicles.
4. Secure the product to prevent it from slipping or falling over.

Troubleshooting

| Problem | Possible Cause | Solution |
|---|--|---|
| Motor fails to start when trigger switch is depressed | Battery is not secure Battery is not charged | To secure the battery pack, make sure the latches on the top of the battery pack snap into place Charge the battery pack according to the instructions |
| Motor runs, but cutting blades do not move | Trimmer damaged Do not use string trimmer | Call for technical service |
| Trimmer smokes during operation | Trimmer damaged Do not use string trimmer | Call for technical service |
| Cutting line does not advance | Line may be tangled on spool Line has run out | Remove battery. remove spool cover and spool. unwind spool and rewind, ensuring that line is not tangled Replace spool or spool line. |

Guarantee

Guarantee

Dear Customer,

This equipment is provided with a 2-year guarantee from the date of purchase. In case of defects, you have statutory rights against the seller of the product. These statutory rights are not restricted by our guarantee presented below. Terms of Guarantee the term of the guarantee begins on the date of purchase, please retain the original receipt and it's required as proof of purchase. If a material or manufacturing defect occurs within 2-year of the date of the purchasing, we will repair or replace the product for you free of charge.

This guarantee requires the defective equipment and proof of purchase to be presented within the 2-year period with a brief written description of what constitutes the defect and when it occurred. If the defect is covered by our guarantee, you will receive either the repaired product or a new product. No new guarantee period begins on repair or replacement of the product.

Guarantee Period And Statutory Claims For Defects

The guarantee period is not extended by the guarantee service. This also applies for replaced or repaired parts. Any damages and defects already present at the time of purchase must be reported immediately after unpacking.