

SYVIO

#SY-H001# INSTRUCTION MANUAL Warm & Cool Mist Humidifier

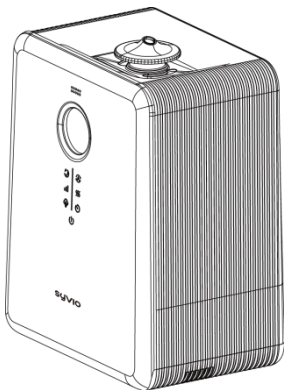

Please read this manual carefully before use and keep it properly for future reference.

NAMED OF PARTS

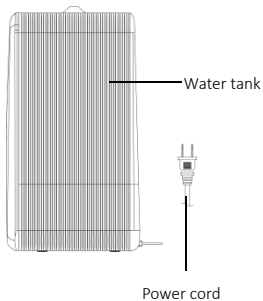
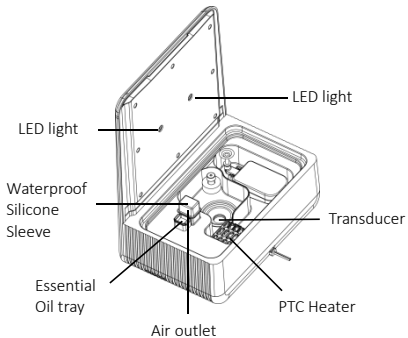
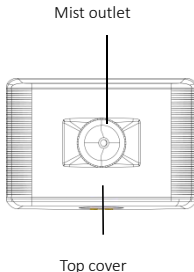
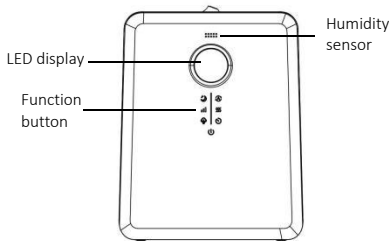

FUNCTION CHARACTERISTICS

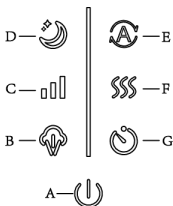

A. Power Button

Press button A to turn the humidifier ON and OFF.

B. Turbo Mode

High mist volume setting, fasten fan speed and heating function are all turned on.

C. Mist Volume

When it is on, the unit will default to the medium mist output. 1st press: high mist output. 2nd press: low mist output. Low, medium and high mist corresponding to display L1, L2, L3.

D. Sleep Mode/ Night Light

1. Press button D. The screen is off; the sleep icon flashes 3 times and then becomes weakly bright; all other lights are off; the sleep mode works with low mist;
2. Touch the button D twice to turn off the night light. (Touch button D twice for night light control)

E. AUTO Mode

1. Press button E, the humidity value on the display will flash, and humidity value increases by 5% with each press during flashing. If no operation is performed within 3 seconds during flashing, it will enter the automatic constant humidity mode and stop flashing. Humidity range: 40%~80%.

Automatic constant humidity mode. Keep at the mist level before auto mode entering.

For example, if the medium mist is used before entering the Auto mode, after entering the Auto mode, it is still the medium humidification.

Note: When the room humidity is higher than the humidity value set by the unit, the unit

will stop working, until the room humidity is lower than the humidity value set by the unit, the unit will start to work.

F. Heating Mode

Press button F to switch heating ON/OFF.

G. Timer Setting

Press button G to determine the operating time, it can be set 1-12 hours or for continuously operation.

Water Shortage Protection: The display E2 flashes within 5 seconds of water shortage, and E2 is shown in screen after 5 seconds. If the water shortage state is not turned off within 30 seconds, the unit will automatically shut down.

ROMOTE CONTROL

Power Button

Short Press: Turn On/Off

Mist Volume

Short Press: Low, Medium, High

Night Light

Short Press: Turn On/Off

AUTO Mode

Short Press: Set or Cancel

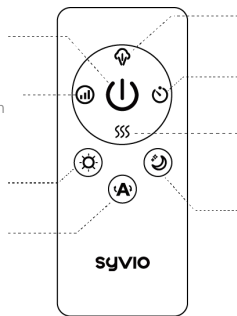

Turbo Mode

Short Press: Set or Cancel

Timer Setting

Short Press: Set or Cancel

Heating Mode

Short Press: Turn On/Off

Sleep Mode

Short Press: Set or Cancel

CLEANING

Note: Always unplug the unit before servicing in any way.

GENERAL CLEANING

- Inside the base of the unit. Pour excess water out of the unit, take out the aromatherapy box and close the cleaning cap. Wash out the unit with fresh water using the cleaning brush and a soft cloth as needed. Do not submerge the base of the unit into water, or allow water to enter inside the dry air exhaust port of the unit.
- Water tank. Empty water tank. Remove mist nozzle and clean the mist tube with fresh water and a light brush (bottle cleaning brush is recommended).
- Outer surface of the unit. Wipe the surface of the unit with a soft, damp cloth if needed. If you notice an accumulation of water during usage, reduce humidity and dry outer surface with a cloth.

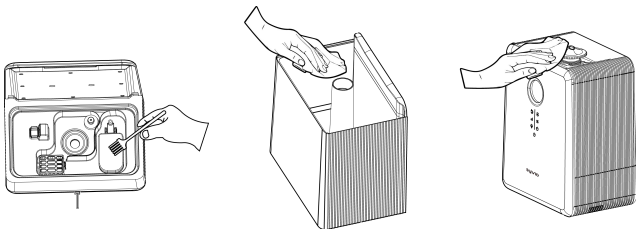

DESCALING

- As the water type difference and for your health, cleaning or scale removing (if have) every three days is required to optimize unit performance.
- Use ONLY the enclosed cleaning brush to gently clean disk and remove build up and deposits.
- Do not scrub or scrape the ultrasonic disk.

ULTRASONIC DISK

1. Unplug unit.

2. Remove the tank and empty all the water in the base and tank.
3. Locate the ultrasonic disk on the inner center of the base unit.
4. Use ONLY the enclosed cleaning brush to gently clean disk and remove build up and deposits.

Do not scrub or scrape the ultrasonic disk.

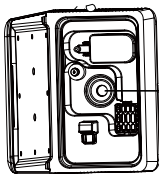

*Clean the disk with the brush only. No other cleaning tool should be used. BRUSH ONLY.

Ultrasonic Disk

If scale becomes difficult to remove with brush:

1. Make a cup of mixture by adding 1 tsp of white vinegar and 1 tsp of water.
2. Let solution stand on for 5 minutes.
3. Cover the cleaning cap and remove the diffuser box, pour the mixture into the base, clean all interior surfaces with a soft cloth or brush to help remove scale.
4. Also check mist nozzle and mist tube in water tank. Clean as needed.
5. Rinse the Base thoroughly with water to remove scale and the residual vinegar solution.

STORAGE

- Follow the Cleaning and Descaling instructions when the humidifier will be not in use for a long period.
- Dry the humidifier completely before storing. DO NOT store with water inside the Base or Water Tank.
- Pack the unit in its original box and store in a cool, dry location.

NOTE: IF YOU EXPERIENCE A PROBLEM DO NOT ATTEMPT TO OPEN THE MOTOR HOUSING YOURSELF. DOING SO MAY VOID YOUR WARRANTY AND CAUSE DAMAGE TO THE HUMIDIFIER OR PERSONAL INJURY.

Power	≤90W
Voltage	AC 120V 60Hz
Mist Volume	Cool Mist 300ml/h Max Warm Mist 500ml/h Max
Working Time	Cool Mist: 50H(low mist), 20H(high mist) Warm Mist: 30H(low mist), 12H(high mist)
Capacity	6L
Timer	1H-12H
Size	249(L) x 172(W) x 315(W) mm

INSTRUCTIONS FOR USE

Select a firm and flat location - at least six inches (15 cm) from any well or wall or object for proper air flow. Place the humidifier on a water-resistant surface, as water can damage furniture and some flooring. Do not place unit directly on carpet, towels, blankets or other absorbent surfaces.

1. Remove the Top Cover from the water tank.
2. Pour cool, clean water directly into the tank, work best with purified water. Note: Please do not over the Max Line, the best at Best Line.
3. Place water tank cover back and make sure the unit is plugged, the turn it on to enjoy health life.

Water can be added to the tank from Top Cover.

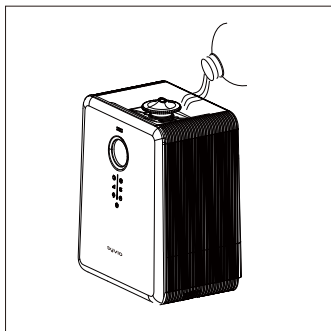
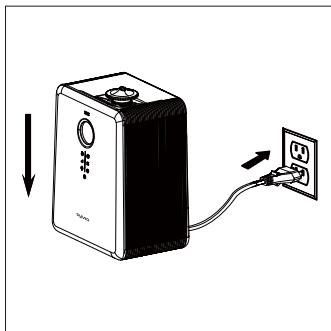
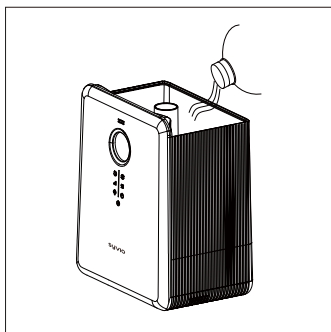
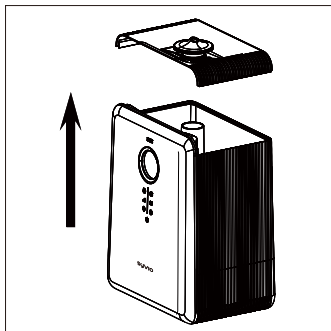

CARE & MAINTENANCE

Do not add hot water, only suitable for cold water.

Please use the original power cord.

Always unplug the power cord from electrical outlet before filling.

Essential oil should not come in contact with the exterior surface of unit.

Do not submerge unit into water to avoid risk of exterior surface of unit.

Do not submerge unit into water to avoid risk of electric shock.

Do not put fingers, hands, or any object into the unit while operating.

Do not attempt to adjust or repair the unit.

Do not touch the water while unit is operating.

Do not fill water through the Mist Outlet or the Air Outlet.

Do not place the unit near heat sources or direct sunlight.

Use two hands when moving your humidifier

Please follow the instruction manual to operate the unit.

TROUBLE SHOOTING

Problem	Possible Factors	Solution
Will not turn on or turn off?	Not enough water in the tank	Please add enough water to the tank, not exceeding the Max water line.
	The power cord connects not properly	Please disconnect the cord, check the cables and reconnect carefully.
Will not put out mist	Not enough water or too much in the tank	Please add enough water to the tank, not exceeding the Max water line.
	The "Mist Outlet" has dirt	Just clean the "mist outlet" put it in a cool place and wait for it to dry naturally, then it can be used normally.
	The "Air Intake" port under the base has dirt	Clean the "air intake" with a dry brush.
E2 appears on the display	Indicates low water	1. Unplug the unit then refill tank. 2. E2 code still appears after adding water. Please pour out the water in the water tank first, and then press the water inlet valve of the water tank several times with your finger. Add water when the valve can move smoothly.

Get Help Fast

"Thanks for purchasing the SYVIO Product!"

If there is any problem, please contact us for a replacement or refund.

Also, register your order id for an EXTRA 3-months warranty!

Support Email: support@mysyvio.com"